



THE COMPUTER'S PERSONAL AGAIN.

HP Pavilion PC
QUICK SETUP

SNELLE INSTALLATIE
CONFIGURAÇÃO RÁPIDA

Location, availability, and number of connectors may vary.
De locatie, beschikbaarheid en het aantal connectors kunnen variëren.
A localização, disponibilidade e número de fichas poderão variar.

1 Keyboard and Mouse

Wired option

Match the colors.

Bekabelde optie

De kleuren afstemmen.

Opção com fio

Corresponder as cores.



or
ou

Wireless option

Refer to the setup instructions located in your keyboard box.

NOTE: The same receiver controls both the keyboard and mouse.

Draadloze optie

Raadpleeg de installatie-instructies die bij uw toetsenbord werden geleverd.

OPMERKING: Het toetsenbord en de muis worden door dezelfde ontvanger aangestuurd.

Opção sem fios

Consulte as instruções de configuração localizadas na caixa do teclado.

NOTA: O mesmo receptor controla o teclado e o rato.



Toetsenbord en muis
Teclado e rato



2 Monitor

Monitor
Monitor

Refer to the setup instructions that came with your monitor.
Monitors may be sold separately.

Raadpleeg de installatie-instructies van uw monitor.

Monitoren worden mogelijk afzonderlijk verkocht.

Consulte as instruções de configuração fornecidas com o monitor.

Os monitores podem ser vendidos em separado.



3 Speaker System

Luidsprekersysteem
Sistema de altifalantes

Refer to the setup instructions that came with your speakers. Speakers may be sold separately.
Raadpleeg de installatie-instructies die geleverd werden bij uw luidsprekers. Luidsprekers worden mogelijk afzonderlijk verkocht.

Consulte as instruções de configuração fornecidas com os altifalantes. Os altifalantes podem ser vendidos em separado.

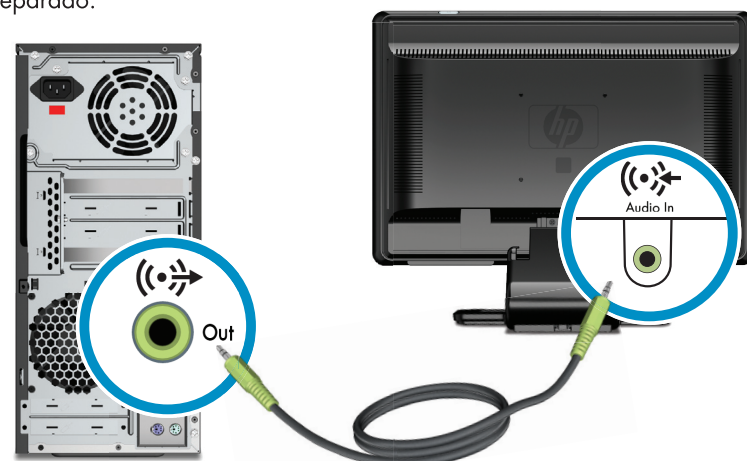

4 Connect Power

Stroom aansluiten
Ligar alimentação

Computer to electrical outlet. Grounded connection or connection to surge protector is recommended.
Computer naar stopcontact. Geaarde aansluiting of aansluiting op stroomstootbeveiliging is aanbevolen.
Computador para tomada eléctrica. É recomendada uma ligação à terra ou ligação a um protector contra picos de corrente.

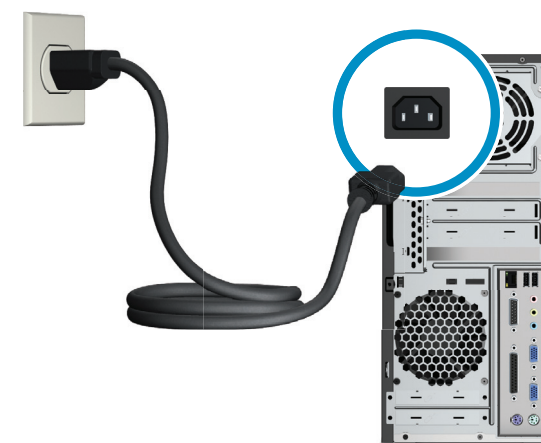

5 LAN/Modem

LAN / Modem
LAN / Modem

Connect your LAN (Ethernet) cable to computer.
Cable not included.

Sluit uw LAN-kabel (Ethernet) aan op de computer. Kabel niet inbegrepen.

Ligue o cabo LAN (Ethernet) ao computador. Cabo não incluído.

Connect modem to computer.
Select models only.

Sluit de modemkabel aan op de computer. Alleen bepaalde modellen.

Ligue o cabo do modem ao computador. Apenas nos modelos seleccionados.

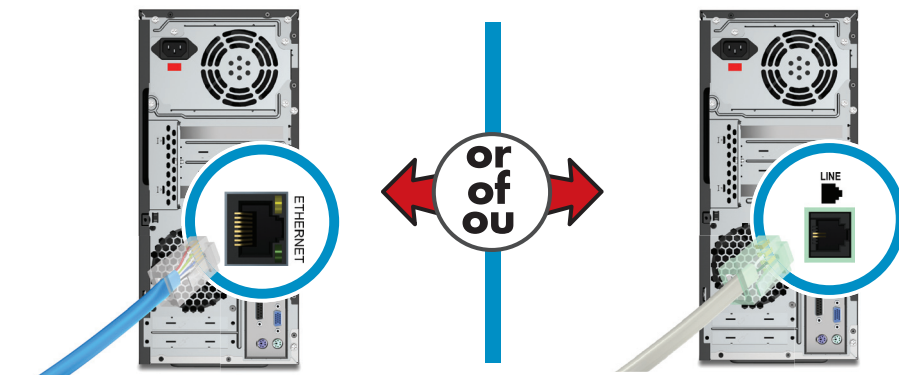

6 Power On

Inschakelen
Alimentação ligada



Please be patient while the computer starts for the first time. It may take 10 to 60 minutes, and you may see blank screens. **Do not turn off the computer during this process.**

Even geduld wanneer de computer voor de eerste maal wordt opgestart. Het kan 10 tot 60 minuten duren, en u krijgt mogelijk lege schermen te zien. **Schakel uw computer niet uit tijdens dit proces.**

Seja paciente enquanto o computador inicia pela primeira vez. Poderá demorar entre 10 e 60 minutos, e poderá ver ecrãs em branco. **Não desligue o computador durante este processo.**

LOCATING YOUR USER'S GUIDES

Hewlett-Packard is committed to reducing the environmental impact of our products. As part of our continuing efforts, the following documents may be located on your hard disk drive for your reference:

- Getting Started guide
- Upgrading and Servicing Guide

To view the documents:

- 1 Click the **Windows Start Button**®.
- 2 Select **All Programs**.
- 3 Select **User Guides**.

UW GEBRUIKERSHANDLEIDINGEN VINDEN

Hewlett-Packard engageert zich om de milieuvuiling van zijn producten te verminderen. Als onderdeel van deze aanhoudende inspanningen, vindt u mogelijk de volgende documenten op uw vaste schijf ter referentie:

- Aan de slag
- Handleiding Upgrade en Service

Om de documenten weer te geven:

- 1 Klik in **Windows op de knop Start**.
- 2 Kies **Alle programma's**.
- 3 Selecteer **Gebruikershandleidingen**.

LOCALIZAR OS SEUS GUIAS PARA USUÁRIOS

A Hewlett-Packard está empenhada em reduzir o impacto ambiental dos nossos produtos. Como parte dos nossos esforços continuados, os seguintes documentos poderão ser encontrados na unidade do seu disco rígido para sua consulta:

- Manual de Introdução
- Manual de actualização e manutenção

Para ver os documentos:

- 1 Clique **Botão Iniciar do Windows**.
- 2 Selecciona **Todos os programas**.
- 3 Selecciona **Guias para Usuários**.



Copyright © 2007 Hewlett-Packard Development Company, L.P.
Printed in HP.COM/PERSONAL

