



THE COMPUTER IS PERSONAL AGAIN.

Location, availability, and number of connectors may vary.
接頭位置、可用性及數量可能會有所不同。

QUICK SETUP
快速安裝

Keyboard and Mouse

Wired option. Match the colors.

鍵盤和滑鼠

接線選擇。請對照顏色接線。

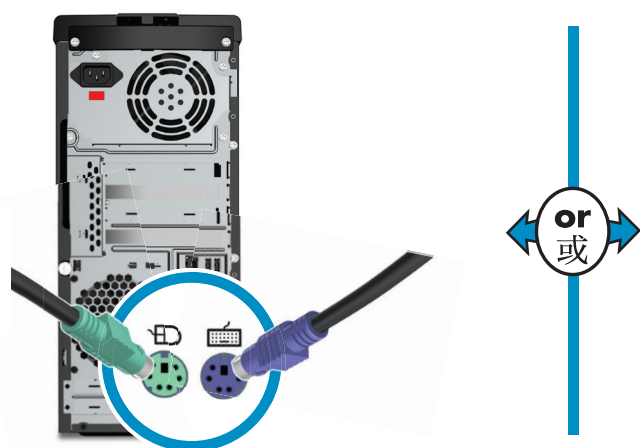

Wireless option. Refer to the setup instructions located in your keyboard box.

NOTE: The same receiver controls both the keyboard and mouse.

無線連接選擇。請參閱鍵盤包裝盒上的安裝說明。

注意事項：鍵盤和滑鼠由同一個接收器控制。

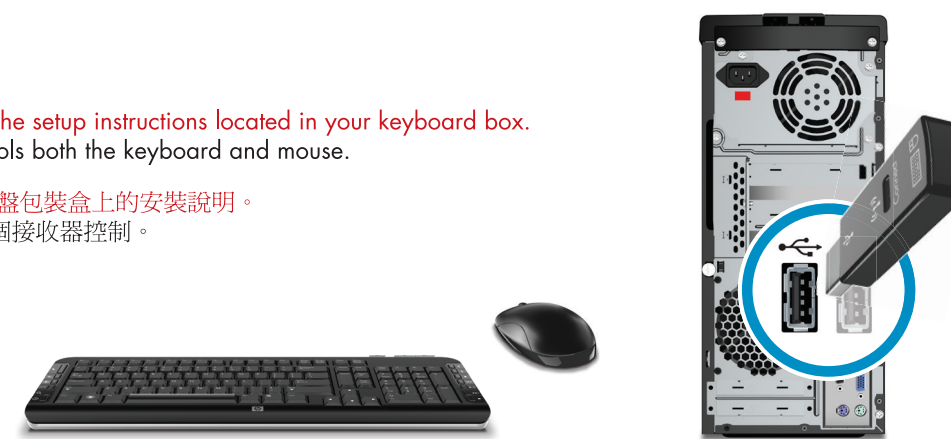

Monitor

Refer to the setup instructions that came with your monitor.
Monitors may be sold separately.

顯示器

請參閱顯示器隨附的安裝說明。
顯示器可能為另行販售。

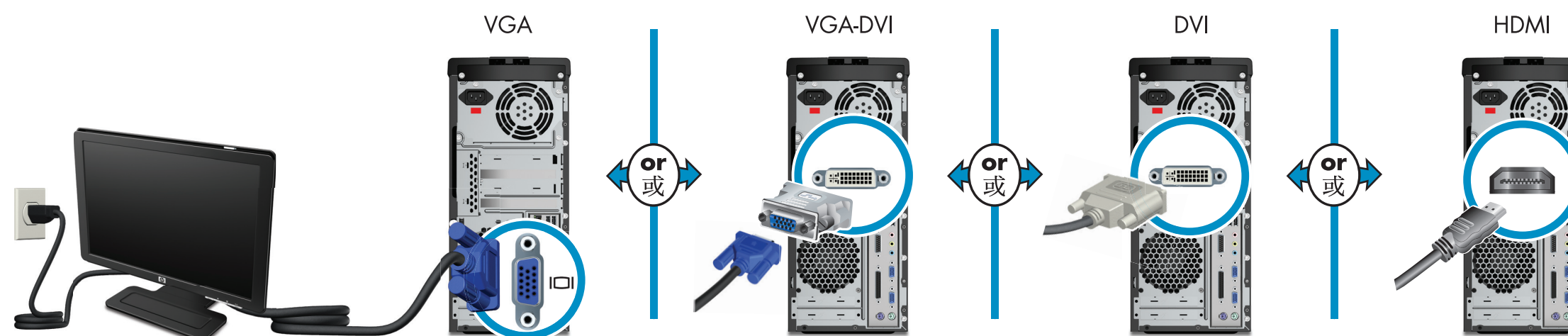

Speakers

Refer to the setup instructions that came with your speakers.
Speakers may be sold separately.

喇叭

請參閱喇叭隨附的安裝說明。
喇叭可能為另行販售。

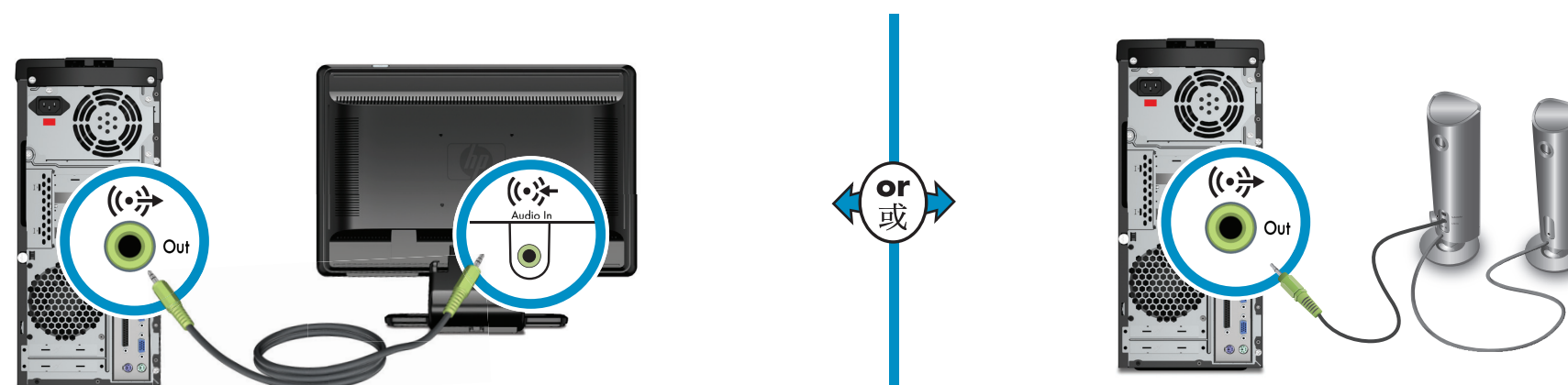

Connect Power

Computer to electrical outlet. Grounded connection or connection to surge protector is recommended.

連接電源

將電腦連接到電源插座。
建議使用接地線或連接至穩壓器。

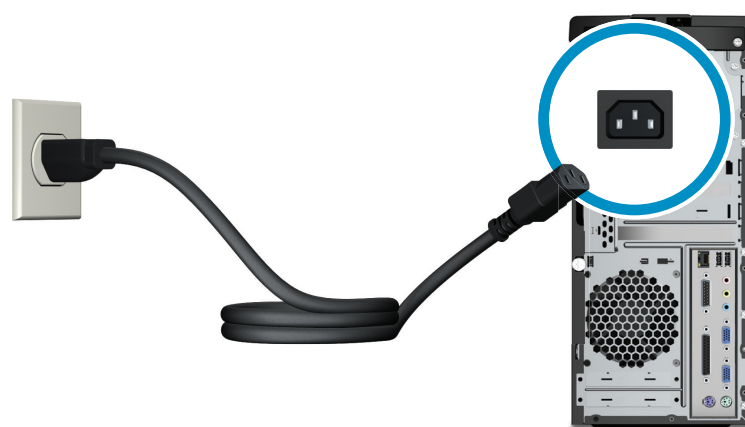

LAN / Modem

區域網路 / 數據機

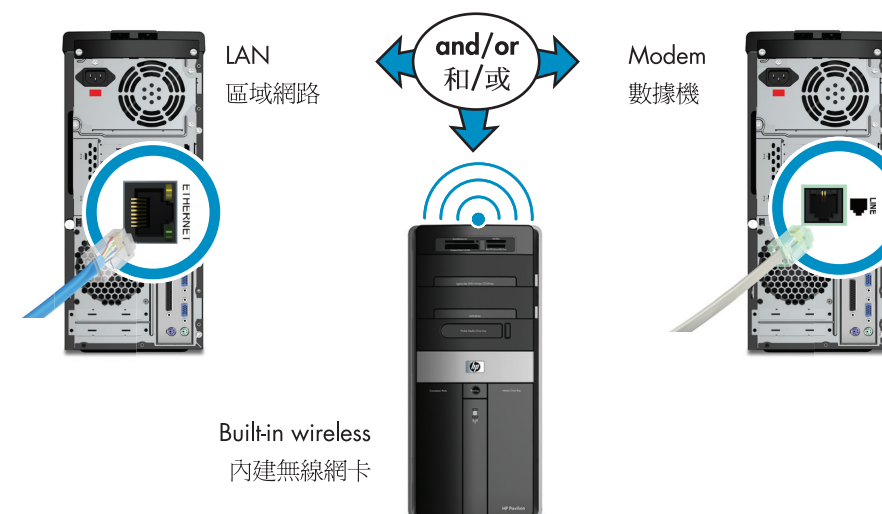

Power On

開啓電源



STARTUP MAY TAKE:

20 MINUTES

Do not turn off the computer during this process.



啟動時間可能需要：

20 分鐘

請勿在此程序執行期間關閉電腦。

LOCATING YOUR USER'S GUIDES

Hewlett-Packard is committed to reducing the environmental impact of our products. As part of our continuing efforts, the following documents may be located on your hard disk drive for your reference:

- Getting Started guide
- Upgrading and Servicing Guide

To view the documents:

- 1 Click **Windows Start Button**.
- 2 Select **Help and Support**.
- 3 Select **User guides**.

找到您的使用手冊

Hewlett-Packard 承諾要降低產品對環境造成的影響。在我們持續不斷的努力下，您可以在硬碟上找到下列文件以供參閱使用：

- 《快速入門手冊》
- 《升級與維護手冊》

若要查看文件：

- 1 按一下 **[Windows 開始按鈕]**。
- 2 選取 **【說明及支援】**。
- 3 選取 **【使用手冊】**。



Copyright © 2008 Hewlett-Packard Development Company, L.P.
Printed in HP.COM/PERSONAL